

# Thank you for purchasing BBFOR1 Transit Ignition Removal Tool

[barrelbustertools.co.uk/bbfor1](http://barrelbustertools.co.uk/bbfor1)



This tool enables quick and easy removal of jammed ignition barrels on Ford Transit and Transit Custom vehicles.

## Vehicle fitment

- Transit: 2014–2024
- Transit Custom: 2013–2024

## Preparation before drilling **IMPORTANT**

- Apply lubricant to the inner sleeve of the drill hole.
- Set the drill mode to drill (not hammer or torque).
- Ensure steering column adjuster is locked.

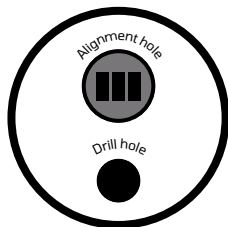

## Instructions for use

1. Remove the upper and lower ignition cowling, then remove the transceiver (aerial ring).
2. Insert the **barrel preload alignment plug** (with the lip facing outwards) fully into the barrel. This aligns the internal cylinder and assists with extraction.
3. Position the clamp onto the ignition barrel and loosely install the supplied screws.
4. Rotate the clamp until the position III markings on the ignition barrel are centered in the alignment hole.
5. Tighten both screws securely to lock the clamp in place.
6. Recheck the alignment hole to confirm the clamp has remained correctly aligned.
7. Apply lubricant to the inner sleeve of the drill hole and drill bit.
8. Fit the drill bit into the drill to the end stop and tighten securely.
9. Set the drill mode to drill (not hammer or torque)
10. Begin drilling at a medium speed with steady pressure applied, withdrawing the bit every few seconds to clear any accumulated swarf.
11. When the drill bit reaches the end stop guide, remove the drill and clamp tool.
12. Insert the supplied punch tool into the ignition release hole. Operate the slide hammer repeatedly while pulling on the barrel.
13. The ignition barrel should now slide out.

**Remove the barrel preload alignment plug  
after drilling for use on next barrel**



## Fitting a new ignition barrel after removal

To install a new barrel after extraction, use the adjustment tool to turn the rear of the steering housing to the correct position, then proceed to fit the new barrel as normal.



**Safety Goggles  
Required**



**Take steps to  
drill safely**



## BBFOR1 Quick Guide

Detailed guide overleaf

1

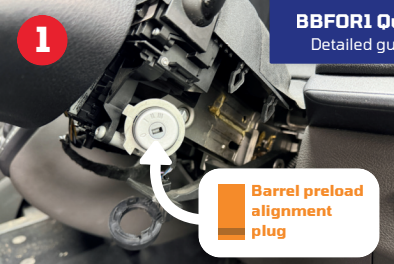

1) Remove cowling and transceiver (aerial ring) & lock the steering column adjuster. Insert the barrel preload alignment plug fully into the barrel.

2



2) Attach clamp, then rotate until the position III markings on the ignition barrel are centered in the alignment hole.

3

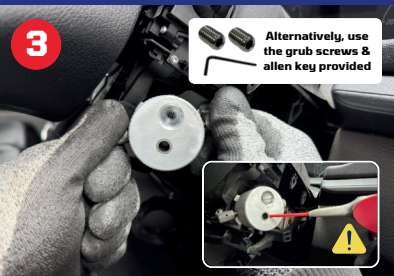

3) Tighten both screws securely to lock the clamp in place. Recheck the alignment hole to confirm it remains correctly aligned. Apply lubricant to the drill bit and drill hole.

4



4) Fit the drill bit into the drill to the end stop and tighten securely. Set the drill to drill mode (not hammer or torque). Insert drill bit into the drill hole on the clamp.

5



5) Begin drilling at medium speed with steady pressure applied, withdrawing the bit every 5 seconds to clear swarf. Stop at the end guide, then remove the bit.

6



6) Remove the clamp, insert the supplied punch tool into the ignition release hole, and operate the slide hammer repeatedly while pulling on the barrel until it slides out.

For instructions on how to fit a replacement barrel after removing the old one, please see overleaf.



**Safety Goggles Required**

